

MPC70 - Permanent Split Capacitor (PSC) Gearmotor

Construction Features:

- Class B insulation
- Aluminum construction for strength and heat dissipation
- Ball bearings used for the motor and gearbox
- Reliable, low noise and long life
- Permanently grease lubricated gearbox
- Reversible
- Continuous duty

Applications:

- Office equipment
- Conveyor drive
- Valve actuators
- Food machinery
- Medical equipment
- Industrial machinery

Options:

- Output Shaft
- Leads
- Voltage/frequency
- Gearbox lubrication
- Motor shaft extension

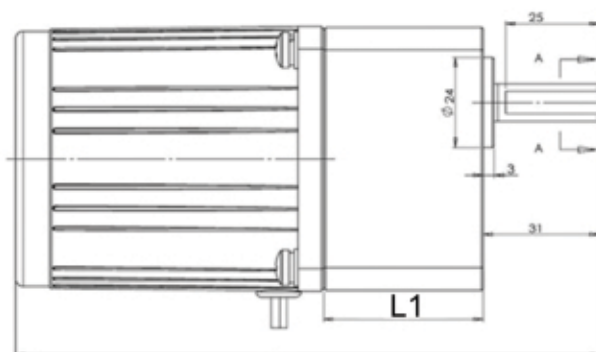
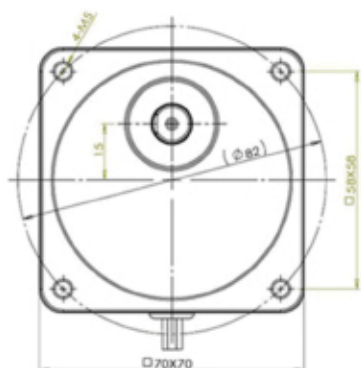

L2

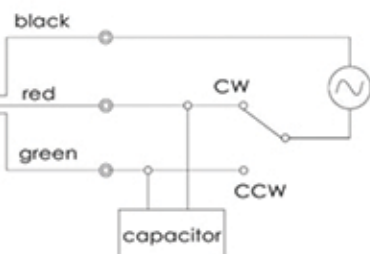
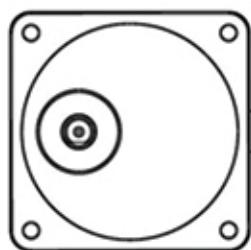

Power: 15 Watt
Motor Speed: 1740 RPM

Ratio		3	5	9	12.5	15	20	25	30	40	50	60	70	90	100	140	180	364
Rated Speed	RPM	580	348	193	139	116	87	69.6	58	43.5	34.8	29	24.9	19.3	17.4	12.4	9.7	4.8
Rated Torque	in-lbs	2.7	5.3	8.9	12.4	15	19.5	24.8	30.1	39.8	49.6	59	69	89	99.1	139	180	180
Geadhead (L1)	mm	34												42.5				
Gearmotor (L2)	mm	143												155				